

SUN-X

Technical Data – sunbotics Robot

		Robot 110 cm	Robot 145 cm	Robot 210 cm
Metrics	Width	1.100 mm *	1.450 mm	2.100 mm
	Length		1.550 mm	
	Height		380 mm	

Weight	Central unit	17 kg		
	Chassis	31 kg		32,5 kg
	Brush unit	2x 18 kg	2x 20,5 kg	2x 25 kg
	Total ²	84 kg	89 kg	99,5 kg
	Load calculation ³	3.820 Pa	3.910 Pa	4.160 Pa

Operating data	Maximum speed	25 $\frac{m}{min}$		
	Cleaning speed ¹	1.470 $\frac{m^2}{h}$	1.940 $\frac{m^2}{h}$	2.790 $\frac{m^2}{h}$
	Max. inclination of modules ⁴	25°		20°
	Water supply ⁵	0-600 $\frac{l}{h}$; 2-4 bar		
	Battery performance ¹	120 min		90 min
	Brush rotation	200 rpm		

Extras	- Modular build
	- Warning system for low batteries
	- Maintenance package for small repairs on sight
	- Protection class for motors (imperviousness) IP 65
	- Splash guards for additional protection of motors
	- Adjustable water flow

Nr.	Baugruppe
1	Central unit
2	Chassis
3	Brush unit

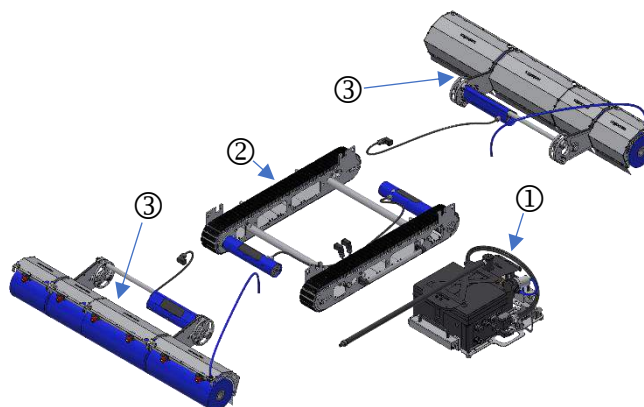

* Regular width of solar systems with east/west mounting

Robot 110 cm

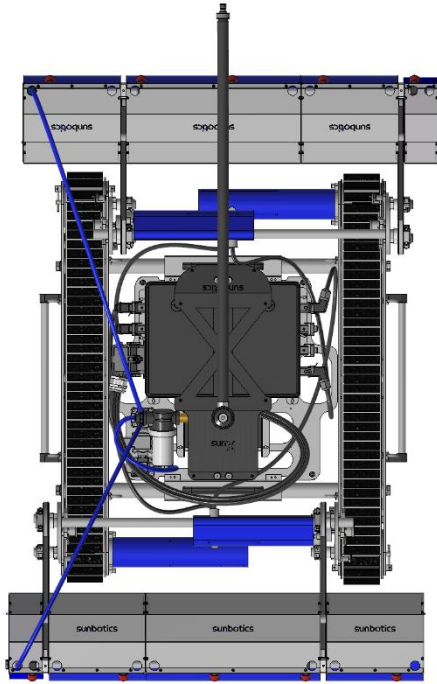

Robot 145 cm

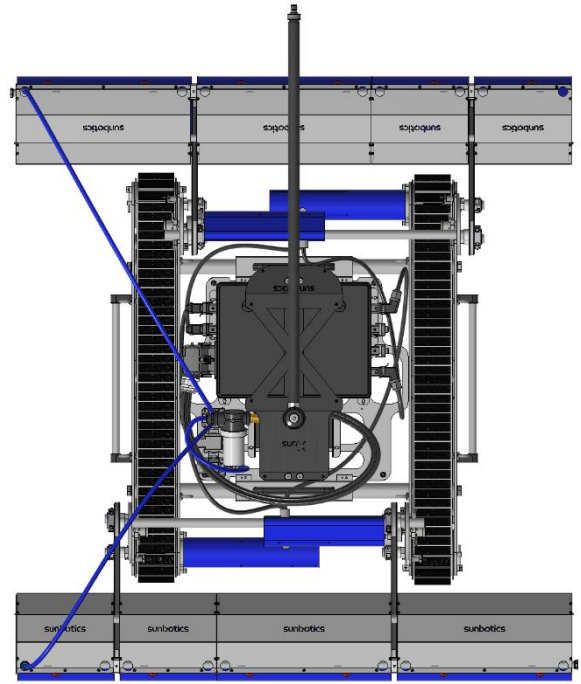

Robot 210 cm

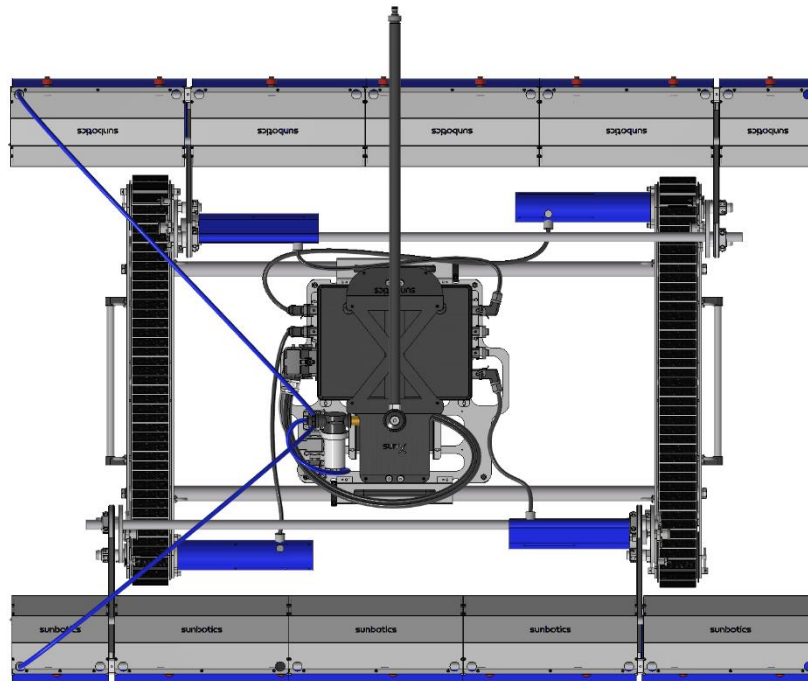

¹ The maximum value is specified here
² Specifications given without battery
³ Specified loads with brush in place on surface
⁴ The slopes specified are those approved by sun-X GmbH.
 The operator is responsible for the safe operation of the machine (observe the operating instructions).
⁵ A consumption of 0 l refers to dry cleaning

Certificates

